



Leicester
City Council

LICENSING (HEARINGS) SUB-COMMITTEE

DATE: MONDAY, 12 MAY 2025

TIME: 10:00 am

PLACE: Meeting Room 1.13, First Floor, City Hall, 115 Charles Street, Leicester, LE1 1FZ

Members of the Sub-Committee

Councillors Pickering, Cank and Joshi

Members of the Sub-Committee are summoned to attend the above meeting to consider the items of business listed overleaf.

for Monitoring Officer

Officer contact:

Katie Jordan, Governance Services Officer / Julian Yeung, Governance Services Officer, email:
committees@leicester.gov.uk

Information for Members of the Public

Attending meetings and access to information

You have the right to attend formal meetings such as full Council, committee meetings, City Mayor & Executive Public Briefing and Scrutiny Commissions and see copies of agendas and minutes. On occasion however, meetings may, for reasons set out in law, need to consider some items in private.

Dates of meetings and copies of public agendas and minutes are available on the Council's website at www.cabinet.leicester.gov.uk, from the Council's Customer Service Centre or by contacting us using the details below.

Making meetings accessible to all

Wheelchair access – Public meeting rooms at the City Hall are accessible to wheelchair users. Wheelchair access to City Hall is from the middle entrance door on Charles Street - press the plate on the right hand side of the door to open the door automatically.

Braille/audio tape/translation - If you require this please contact the Governance Support Officer (production times will depend upon equipment/facility availability).

Induction loops - There are induction loop facilities in City Hall meeting rooms. Please speak to the Governance Support Officer using the details below.

Filming and Recording the Meeting - The Council is committed to transparency and supports efforts to record and share reports of proceedings of public meetings through a variety of means, including social media. In accordance with government regulations and the Council's policy, persons and press attending any meeting of the Council open to the public (except Licensing Sub Committees and where the public have been formally excluded) are allowed to record and/or report all or part of that meeting. Details of the Council's policy are available at www.leicester.gov.uk or from Governance Services.

If you intend to film or make an audio recording of a meeting you are asked to notify the relevant Governance Support Officer in advance of the meeting to ensure that participants can be notified in advance and consideration given to practicalities such as allocating appropriate space in the public gallery etc..

The aim of the Regulations and of the Council's policy is to encourage public interest and engagement so in recording or reporting on proceedings members of the public are asked:

- ✓ to respect the right of others to view and hear debates without interruption;
- ✓ to ensure that the sound on any device is fully muted and intrusive lighting avoided;
- ✓ where filming, to only focus on those people actively participating in the meeting;
- ✓ where filming, to (via the Chair of the meeting) ensure that those present are aware that they may be filmed and respect any requests to not be filmed.

Further information

If you have any queries about any of the above or the business to be discussed, please contact us on committees@leicester.gov.uk, or call in at City Hall.

For Press Enquiries - please phone the **Communications Unit on 0116 454 4151**.

LEICESTER CITY COUNCIL LICENSING SUB-COMMITTEE PROCEDURAL GUIDE

INTRODUCTORY PHASE

The meeting will be held in public unless stated otherwise in the report.

Present at the hearing will be Members of the Licensing Sub-Committee (minimum 3 Members), Officers from the Licensing Authority, a Legal Adviser to the Sub-Committee, an Officer from Governance Services.

1. Participants at the meeting will introduce themselves as follows:
 - a. Members and Officers
 - b. Statutory Consultees (if any)
 - c. The Applicant and any representatives
 - d. Persons who have made representations
2. The Chair will check that the Applicant has received a copy of the Officer report.

INFORMATION GATHERING

(*Please Note – for the purposes of a hearing to determine an application in a Cumulative Impact Zone (CIZ), the Applicant will present their case first)

3. The Licensing Officer presents the report (previously circulated)

Questions (for clarification purposes only):
Members
Statutory Consultees (if any)
Persons who have made representations
Applicant and Representative(s)
4. Depending on the nature of the report, Statutory Consultees present their comments.

Questions (for clarification purposes only):
Members
Officers
Persons who have made representations
Applicant and Representative(s)
5. Persons who have made representations

Questions (for clarification purposes only):
Members
Officers
Statutory Consultees (is any)
Applicant and Representative(s)
6. *Applicant's Case

Questions (for clarification purposes only):
Members
Officers

Statutory Consultees
Persons who have made representations

7. Summing up in the following order

Officers
Statutory Consultees
Persons who have made representations
*Applicant and Representative(s)

8. The Legal Adviser to the Sub-Committee to advise the Sub-Committee in the presence of the Applicant, Representatives, Officers, Statutory Consultees, and persons who have made representations on relevant issues the Members need to be aware of when they come to make their decision.

DECISION MAKING

9. Apart from the Sub-Committee Members and the Governance Support Officer everyone will be asked to withdraw from the meeting The Legal Adviser to the Sub-Committee may be called back to the meeting to advise on the wording of the decision the Sub-Committee Members will have made during private deliberation.
10. The Applicant will be advised that the decision made by the Sub-Committee will be made public within 5 working days of the meeting.

PUBLIC SESSION

AGENDA

FIRE / EMERGENCY EVACUATION

If the emergency alarm sounds, you must evacuate the building immediately by the nearest available fire exit and proceed to the area outside the Ramada Encore Hotel on Charles Street as directed by Governance Services staff. Further instructions will then be given.

- 1. Appointment of Chair**
- 2. Apologies for Absence**
- 3. Declarations of Interest**

Members are asked to declare any interests they may have in the business to be discussed.

- 4. Application for a Variation of an Existing Premises Licence - Alino, 11 Narborough Road, LE3 0LE** [Appendix A](#)
(Pages 1 - 48)

The Director of Neighbourhood and Environmental Services submits a report for an application for a variation to an existing premises licence for Alino, 11 Narborough Road, LE3 0LE.

- 5. Application for a New Premises Licence - Ranya Leicester Ltd, 24 Braunstone Gate, Leicester, LE3 5LG** [Appendix B](#)
(Pages 49 - 80)

The Director of Neighbourhood and Environmental Services submits a report for an application for a new premises licence for Ranya Leicester Ltd, 24 Braunstone Gate, Leicester, LE3 5LG.

- 6. Any Other Urgent Business**

Application for a variation of an existing premises licence

Licensing (Hearings) Sub-Committee

Decision to be taken by: Licensing (Hearings)
Sub-Committee

Decision to be taken on/Date of meeting: 12 May 2025

Lead director/officer: Tj Mavani

Useful information

- Ward(s) affected: Westcotes
- Report author: Lynsay Coupe
- Author contact details: 0116 454 3065
- Report version number: 1

1. Summary

- 1.1 This report outlines an application under the Licensing Act 2003 for a variation to an existing premises licence for Alino, 11 Narborough Road, LE3 0LE, and summarises the representations received. It also highlights the licensing objectives and the relevant parts of both the statutory guidance and the Licensing Authority's Licensing Policy.

2. Determination to be made

- 2.1 Having considered the application and representations, Members must consider whether to
- Grant the licence without modification
 - Modify the conditions of the licence
 - Reject the whole application

3. Application and promotion of the licensing objectives

- 3.1 An application was received on 21 March 2025 for a variation of an existing premises licence for Alino. A copy of the application is attached at Appendix A.

- 3.2 The variation application is as follows:

Licensable activity	Current hours	Proposed hours
Films Dance Similar to Dance	Monday to Thursday 10.00 – 00.00 Friday to Sunday 10.00 – 01.00	N/A
Live Music	Monday to Thursday 10.00 – 00.00 Friday 10.00 – 01.00 Saturday to Sunday 12.00 – 01.00	Friday to Saturday 10.00 – 03.00
Recorded Music	Monday to Thursday 10.00 – 00.00 Friday to Sunday 10.00 – 01.00	Friday to Saturday 10.00 – 03.00
Late night refreshment	N/A	Friday to Saturday 23.00 – 03.00
Sale of alcohol	Monday to Thursday 10.00 – 00.00	Friday to Saturday 10.00 – 03.00

	Friday to Sunday 10.00 – 01.00	
Opening hours	Unrestricted	Unrestricted

Non standard hours:

Live Music/Recorded Music - Christmas Eve till 4am, New year Eve till 4am

Late Night Refreshment/Sale of alcohol - Christmas Eve till 3am, New year Eve till 3am

Conditions to be removed: None

- 3.3 The steps the applicant proposes to take to promote the licensing objectives are set out in the operating schedule (see section 16 of Appendix A).
- 3.4 The existing licence is attached at Appendix B.
- 3.5 In arriving at its decision on the application, the Licensing Authority's primary consideration must be the promotion of the licensing objectives.
- 3.6 Location Plan



4. Representations

- 4.1 A representation was received on 03 April 2025 from the Police. The representation relates to (the prevention of crime and disorder, the prevention of public nuisance, public safety and the protection of children from harm). The representee is concerned that revellers already under the influence of alcohol will attend the venue in the early hours of the morning to source more alcohol in an area that already faces challenges in relation to crime and disorder and anti-social behaviour. A copy of the representation is attached at Appendix C1.
- 4.2 A representation was received on 09 April 2025 from the Noise team. The representation relates to the prevention of public nuisance. The representee is concerned that allowing the premises to operate such long hours will increase the likelihood of noise complaints and cause disturbance to residents by customers visiting the premises throughout the night and particularly into the early hours of the morning. The Noise team have now reached agreement with the applicant to add conditions to the licence if granted. A copy of the representation/agreement is attached at Appendix C2.

- 4.3 A representation was received on 15 April 2025 from the Licensing Enforcement team. The representation relates to the prevention of crime and disorder, the prevention of public nuisance and public safety. The representee has concerns about the premises and the effects the extended hours may have on the local community, both business and residential. Conditions have been proposed to be added to the licence, if granted. A copy of the representation/proposed conditions are attached at Appendix C3.

5. Conditions

- 5.1 The conditions that are consistent with the application, representation from the Noise Team and proposed conditions from the Licensing Enforcement team are attached at Appendix D.
- 5.2 The Live Music Act 2012 and the Legislative Reform (Entertainment Licensing) Order 2014 amended the Licensing Act 2003 in relation to the provision of regulated entertainment. Certain entertainment does not require a licence subject to audience limits, between 08.00 and 23.00 hours each day. These exemptions may affect the application under consideration because conditions may not be imposed at this stage to control live or recorded music that is unregulated. However, if problems do occur as a result of that entertainment then conditions may be imposed to control such music in the future after a formal review.

6. Statutory guidance and statement of licensing policy

- 6.1 Any decision made by the Licensing Authority must be in accordance with the licensing objectives. In addition, the government has issued guidance under section 182 of the Licensing Act 2003. The parts of the guidance that are particularly relevant in this case are as follows:

Section	Heading
1.2 – 1.5	Licensing objectives and aims
1.15 – 1.16	General Principles
1.17	Each application on its own merits
2.1 – 2.6	Crime & Disorder
2.7 – 2.14	Public Safety
2.15 – 2.21	Public nuisance
2.22 – 2.31	Protection of children from harm
8.41 – 8.49	Steps to promote the licensing objectives
9.11 – 9.12	Role of responsible authorities
9.13 – 9.19	Licensing Authorities acting as responsible authorities
9.42 – 9.44	Determining actions that are appropriate for the promotion of the licensing objectives
10.1 – 10.3	Conditions - general
10.8 – 10.9	Imposed conditions
10.10	Proportionality
10.13 - 10.15	Hours of trading
10.25 – 10.66	Mandatory conditions in relation to the supply of alcohol

13.10 – 13.11	Giving reasons for decisions
14.51 – 14.52	Licensing Hours
16.1 – 16.69	Regulated entertainment

- 6.2 The relevant parts of the Licensing Authority's Statement of Licensing Policy are as follows:

Section	Heading
4	Promotion of the Licensing Objectives
5	General Principles
6	Premises Licences and Club Premises Certificates
8	Areas of Specific Interest and Consultation

7. Points for clarification

- 7.1 The applicant and the parties making the representations have been asked to clarify certain points at the hearing, as follows:

By the applicant

1. Whether the applicant considers that the concerns outlined in the representations are valid, and if not why not.
2. In the light of the representations made, whether the applicant wishes to propose any additional steps for the promotion of the licensing objectives.

By the parties making the representations

1. Whether they have any additional information to support the representation they have made.
2. Whether there are any additional steps that could be taken which would be equally effective in the promotion of the licensing objectives.

8. Financial, legal, equalities, climate emergency and other implications

8.1 Financial implications

There are no significant financial implications arising from the contents of this report.
Jade Draper Principal Accountant
24 April 2025

8.2 Legal implications

Legal advice specific to the application will be provided at the meeting by Legal Officers.

8.3 Equalities implications

Under the Equality Act 2010, public authorities have a Public Sector Equality Duty (PSED) which means that, in carrying out their functions, they have a statutory duty to pay due regard to the need to eliminate unlawful discrimination, harassment and victimisation and other conduct prohibited by the Act, to advance equality of opportunity between people who

share a protected characteristic and those who don't and to foster good relations between people who share a protected characteristic and those who don't.

Protected Characteristics under the Equality Act 2010 are age, disability, gender reassignment, marriage and civil partnership, pregnancy and maternity, race, religion or belief, sex, sexual orientation.

There are no direct equalities implications arising from the report. However it is important to consider issues of accessibility to the application process and its associated activities (such as lodging an appeal); The criteria used during determination of an application and its associated activities (such as lodging an appeal).

Signed: Surinder Singh, Equalities Officer
Dated: 24 April 2025

8.4 Climate Emergency implications

There are unlikely to be any significant climate emergency implications directly associated with this report and the licensing process. Aidan Davis, Sustainability Officer, Ext 28 3384.

8.5 Other implications

Crime and Disorder – see paragraph 4

9. Background information and other papers:

None

10. Summary of appendices:

Appendix A – Application

Appendix B – Existing licence

Appendix C – Representations

Appendix D – Conditions consistent with the application and representation from the Noise Team and proposed conditions from the Licensing Enforcement team

11. Is this a private report (If so, please indicate the reasons and state why it is not in the public interest to be dealt with publicly)?

No

12. Is this a “key decision”? If so, why?

No



Leicester
Application to vary a premises licence
Licensing Act 2003

For help contact
licensing@leicester.gov.uk
 Telephone: +44 116 454 3040

* required information

Section 1 of 18

You can save the form at any time and resume it later. You do not need to be logged in when you resume.

System reference

Not Currently In Use

This is the unique reference for this application generated by the system.

Your reference

You can put what you want here to help you track applications if you make lots of them. It is passed to the authority.

Are you an agent acting on behalf of the applicant?

☐ Yes ☒ No

Put "no" if you are applying on your own behalf or on behalf of a business you own or work for.

Applicant Details

* First name

JEAN ALAIN

* Family name

KAKMENI

* E-mail

Main telephone number

Include country code.

Other telephone number

☐ Indicate here if you would prefer not to be contacted by telephone

Are you:

☒ Applying as a business or organisation, including as a sole trader
☐ Applying as an individual

A sole trader is a business owned by one person without any special legal structure. Applying as an individual means you are applying so you can be employed, or for some other personal reason, such as following a hobby.

Applicant Business

Is your business registered in the UK with Companies House?

☒ Yes ☐ No

Note: completing the Applicant Business section is optional in this form.

Registration number

09820324

Business name

ALINO LTD

If your business is registered, use its registered name.

VAT number

- 252304539

Put "none" if you are not registered for VAT.

Legal status

Private Limited Company

Continued from previous page...

Your position in the business	<input type="text" value="OWNER"/>	
Home country	<input type="text" value="United Kingdom"/>	The country where the headquarters of your business is located.
Registered Address		Address registered with Companies House.
Building number or name	<input type="text" value="11"/>	
Street	<input type="text" value="Narborough Road"/>	
District	<input type="text"/>	
City or town	<input type="text" value="Leicester"/>	
County or administrative area	<input type="text"/>	
Postcode	<input type="text" value="LE3 0LE"/>	
Country	<input type="text" value="United Kingdom"/>	

Section 2 of 18

APPLICATION DETAILS

This application cannot be used to vary the licence so as to extend the period for which the licence has effect or to vary substantially the premises to which it relates. If you wish to make that type of change to the premises licence, you should make a new premises licence application under section 17 of the Licensing Act 2003.

I/we, as named in section 1, being the premises licence holder, apply to vary a premises licence under section 34 of the Licensing Act 2003 for the premises described in section 2 below.

* Premises Licence Number

Are you able to provide a postal address, OS map reference or description of the premises?

☒ Address ☐ OS map reference ☐ Description

Postal Address Of Premises

Building number or name	<input type="text" value="11"/>
Street	<input type="text" value="Narborough Road"/>
District	<input type="text"/>
City or town	<input type="text" value="Leicester"/>
County or administrative area	<input type="text"/>
Postcode	<input type="text" value="LE3 0LE"/>
Country	<input type="text" value="United Kingdom"/>

Premises Contact Details

Telephone number

Continued from previous page...

Non-domestic rateable
value of premises (£)

Section 3 of 18

VARIATION

Do you want the proposed
variation to have effect as
soon as possible?

☒ Yes

☐ No

Do you want the proposed variation to have effect in relation to the
introduction of the late night levy?

☐ Yes

☒ No

You do not have to pay a fee if the only
purpose of the variation for which you are
applying is to avoid becoming liable to the
late night levy.

If your proposed variation
would mean that 5,000 or
more people are expected to
attend the premises at any
one time, state the number
expected to attend

Describe Briefly The Nature Of The Proposed Variation

Describe the premises. For example the type of premises, its general situation and layout and any other information which could be relevant to the licensing objectives. Where your application includes off-supplies of alcohol and you intend to provide a place for consumption of these off-supplies, you must include a description of where the place will be and its proximity to the premises.

The premises is a licensed restaurant and Bar and we have been trading since 2015. It is an open floor plan with a front entrance and back exit, situated in Narborough Road next to Oasis Bar on the right, Bathroom & kitchen on the left. The nature of the propose variation is to change our closing time from 1am to 3am Friday and Saturday in order to satisfier our long loyal customers.

Section 4 of 18

PROVISION OF PLAYS

[See guidance on regulated entertainment](#)

Will the schedule to provide plays be subject to change if this application to
vary is successful?

☐ Yes

☒ No

Section 5 of 18

PROVISION OF FILMS

[See guidance on regulated entertainment](#)

Will the schedule to provide films be subject to change if this application to
vary is successful?

☐ Yes

☒ No

Section 6 of 18

PROVISION OF INDOOR SPORTING EVENTS

Continued from previous page...

[See guidance on regulated entertainment](#)

Will the schedule to provide indoor sporting events be subject to change if this application to vary is successful?

☐ Yes

☒ No

Section 7 of 18

PROVISION OF BOXING OR WRESTLING ENTERTAINMENTS

[See guidance on regulated entertainment](#)

Will the schedule to provide boxing or wrestling entertainments be subject to change if this application to vary is successful?

☐ Yes

☒ No

Section 8 of 18

PROVISION OF LIVE MUSIC

[See guidance on regulated entertainment](#)

Will the schedule to provide live music be subject to change if this application to vary is successful?

☒ Yes

☐ No

Standard Days And Timings

MONDAY

Start

End

Start

End

Provide timings in 24 hour clock (e.g., 16:00) and only give details for the days of the week when you intend the premises to be used for the activity.

TUESDAY

Start

End

Start

End

WEDNESDAY

Start

End

Start

End

THURSDAY

Start

End

Start

End

FRIDAY

Start

End

Start

End

SATURDAY

Start

End

Start

End

Continued from previous page...

SUNDAY

Start

End

Start

End

Will the performance of live music take place indoors or outdoors or both?

☒ Indoors

☐ Outdoors

☐ Both

Where taking place in a building or other structure select as appropriate. Indoors may include a tent.

State type of activity to be authorised, if not already stated, and give relevant further details, for example (but not exclusively) whether or not music will be amplified or unamplified.

State any seasonal variations for the performance of live music

For example (but not exclusively) where the activity will occur on additional days during the summer months.

Non-standard timings. Where the premises will be used for the performance of live music at different times from those listed, above below.

For example (but not exclusively), where you wish the activity to go on longer on a particular day e.g. Christmas Eve.

Christmas Eve till 4am,
New year Eve till 4am

Section 9 of 18

PROVISION OF RECORDED MUSIC

[See guidance on regulated entertainment](#)

Will the schedule to provide recorded music be subject to change if this application to vary is successful?

☒ Yes

☐ No

Standard Days And Timings

MONDAY

Start

End

Start

End

Provide timings in 24 hour clock (e.g., 16:00) and only give details for the days of the week when you intend the premises to be used for the activity.

TUESDAY

Start

End

Start

End

Continued from previous page...

WEDNESDAY

Start

End

Start

End

THURSDAY

Start

End

Start

End

FRIDAY

Start

End

Start

End

SATURDAY

Start

End

Start

End

SUNDAY

Start

End

Start

End

Will the playing of recorded music take place indoors or outdoors or both?

☒ Indoors

☐ Outdoors

☐ Both

Where taking place in a building or other structure select as appropriate. Indoors may include a tent.

State type of activity to be authorised, if not already stated, and give relevant further details, for example (but not exclusively) whether or not music will be amplified or unamplified.

State any seasonal variations for playing recorded music.

For example (but not exclusively) where the activity will occur on additional days during the summer months.

Non-standard timings. Where the premises will be used for the playing of recorded music at different times from those listed above, list below.

For example (but not exclusively), where you wish the activity to go on longer on a particular day e.g. Christmas Eve.

Christmas Eve till 4am,
New Year Eve till 4am

Continued from previous page...

Section 10 of 18

PROVISION OF PERFORMANCES OF DANCE

[See guidance on regulated entertainment](#)

Will the schedule to provide performances of dance be subject to change if this application to vary is successful?

☐ Yes ☒ No

Section 11 of 18

PROVISION OF ANYTHING OF A SIMILAR DESCRIPTION TO LIVE MUSIC, RECORDED MUSIC OR PERFORMANCES OF DANCE

[See guidance on regulated entertainment](#)

Will the schedule to provide anything similar to live music, recorded music or performances of dance be subject to change if this application to vary is successful?

☐ Yes ☒ No

Section 12 of 18

PROVISION OF LATE NIGHT REFRESHMENT

Will the schedule to provide late night refreshment be subject to change if this application to vary is successful?

☒ Yes ☐ No

Standard Days And Timings

MONDAY

Start

End

Start

End

Provide timings in 24 hour clock (e.g., 16:00) and only give details for the days of the week when you intend the premises to be used for the activity.

TUESDAY

Start

End

Start

End

WEDNESDAY

Start

End

Start

End

THURSDAY

Start

End

Start

End

FRIDAY

Start

End

Start

End

Continued from previous page...

SATURDAY

Start

End

Start

End

SUNDAY

Start

End

Start

End

Will the provision of late night refreshment take place indoors or outdoors or both?

☒ Indoors

☐ Outdoors

☐ Both

Where taking place in a building or other structure select as appropriate. Indoors may include a tent.

State type of activity to be authorised, if not already stated, and give relevant further details, for example (but not exclusively) whether or not music will be amplified or unamplified.

State any seasonal variations.

For example (but not exclusively) where the activity will occur on additional days during the summer months.

Non standard timings. Where the premises will be used for the provision of late night refreshment at different times from those listed above, list below.

For example (but not exclusively), where you wish the activity to go on longer on a particular day e.g. Christmas Eve.

Christmas Eve till 3am

New year Eve till 3am

Section 13 of 18

SUPPLY OF ALCOHOL

Will the schedule to supply alcohol be subject to change if this application to vary is successful?

☒ Yes

☐ No

Standard Days And Timings

Continued from previous page...

MONDAY

Start End

Start End

TUESDAY

Start End

Start End

WEDNESDAY

Start End

Start End

THURSDAY

Start End

Start End

FRIDAY

Start End

Start End

SATURDAY

Start End

Start End

SUNDAY

Start End

Start End

Provide timings in 24 hour clock (e.g., 16:00) and only give details for the days of the week when you intend the premises to be used for the activity.

Will the sale of alcohol be for consumption?

☒ On the premises ☐ Off the premises ☐ Both

If the sale of alcohol is for consumption on the premises select on, if the sale of alcohol is for consumption away from the premises select off. If the sale of alcohol is for consumption on the premises and away from the premises select both.

State any seasonal variations.

For example (but not exclusively) where the activity will occur on additional days during the summer months.

Continued from previous page...

Non-standard timings. Where the premises will be used for the supply of alcohol at different times from those listed above, list below.

For example (but not exclusively), where you wish the activity to go on longer on a particular day e.g. Christmas Eve.

Christmas Eve till 3am,
New year Eve till 3am.

Section 14 of 18

ADULT ENTERTAINMENT

Highlight any adult entertainment or services, activities, or other entertainment or matters ancillary to the use of the premises that may give rise to concern in respect of children.

Provide information about anything intended to occur at the premises or ancillary to the use of the premises which may give rise to concern in respect of children, regardless of whether you intend children to have access to the premises, for example (but not exclusively) nudity or semi-nudity, films for restricted age groups etc gambling machines etc.

NONE

Section 15 of 18

HOURS PREMISES ARE OPEN TO THE PUBLIC

Standard Days And Timings

MONDAY

Start

End

Start

End

Provide timings in 24 hour clock
(e.g., 16:00) and only give details for the days
of the week when you intend the premises
to be used for the activity.

TUESDAY

Start

End

Start

End

WEDNESDAY

Start

End

Start

End

THURSDAY

Start

End

Start

End

FRIDAY

Start

End

Start

End

Continued from previous page...

SATURDAY

Start

End

Start

End

SUNDAY

Start

End

Start

End

State any seasonal variations.

For example (but not exclusively) where the activity will occur on additional days during the summer months.

Non standard timings. Where you intend to use the premises to be open to the members and guests at different times from those listed above, list below.

For example (but not exclusively), where you wish the activity to go on longer on a particular day e.g. Christmas Eve.

Christmas Eve: 10am till 4am;
New Year Eve: 10am till 4am

Identify those conditions currently imposed on the licence which you believe could be removed as a consequence of the proposed variation you are seeking.

☐ I have enclosed the premises licence

☐ I have enclosed the relevant part of the premises licence

Reasons why I have failed to enclose the premises licence or relevant part of premises licence.

I have not included the premises license as there is no window to upload one.

Section 16 of 18

LICENSING OBJECTIVES

Describe the steps you intend to take to promote the four licensing objectives:

a) General – all four licensing objectives (b,c,d,e)

List here steps you will take to promote all four licensing objectives together.

Continued from previous page...

After 10 years of trading, we have recently made a massive renovation which included full sound insulation of the premises (wall and ceiling) considerably reduce noise. In order to help the police fighting crime, we have upgraded our CCTV system to an ultimate 4K 30 days recording covering all angle. We currently have a permanent door supervisor Friday and Saturday.

b) The prevention of crime and disorder

Our Staff are trained to identify and prevent potential issues like signs of intoxication and dealing with dispuite customers. CCTV is been install and maintain to deter crime and provide evidence.
In house security personnel with up to date SIA license.

c) Public safety

We have fire extinguishers, fire exits, and emergency lighting in place and are regularly maintained.
we have a first aid box in place.
There is measures to ensure the premises do not become overcrowded by insuring head count.
Accessibility:
The premises are accessible for people with disabilities and that emergency exits are unobstructed.

d) The prevention of public nuisance

We control noise levels by limiting the decibel of our sound system, to prevent disturbance to residents and neighbors.
our premises is fully sound proof;
We do our best to ensure the premises and surrounding area are kept clean and free from litter and debris.
During busy hours outside we do our best to minimize potential nuisance issues, such as queuing or loitering.

We encourage our customers to park their vehicle on the side street to help the traffic flow around the premises to prevent congestion.

e) The protection of children from harm

we have robust age verification procedures in place to prevent underage drinking and entry.
Children under the age of 18 are NOT allow in our premises after 8pm. before this hour, they can only here under parental supervision.
we always ensure the premises are a safe and suitable environment for children, free from any potential hazards or risks.
Our staff are trained on how to identify and deal with underage individuals, and on the importance of protecting children.

Section 17 of 18

NOTES ON REGULATED ENTERTAINMENT

Continued from previous page...

In terms of specific **regulated entertainments** please note that:

- **Plays:** no licence is required for performances between 08:00 and 23.00 on any day, provided that the audience does not exceed 500.
- **Films:** no licence is required for 'not-for-profit' film exhibition held in community premises between 08.00 and 23.00 on any day provided that the audience does not exceed 500 and the organiser (a) gets consent to the screening from a person who is responsible for the premises; and (b) ensures that each such screening abides by age classification ratings.
- **Indoor sporting events:** no licence is required for performances between 08.00 and 23.00 on any day, provided that the audience does not exceed 1000.
- **Boxing or Wrestling Entertainment:** no licence is required for a contest, exhibition or display of Greco-Roman wrestling, or freestyle wrestling between 08.00 and 23.00 on any day, provided that the audience does not exceed 1000. Combined fighting sports – defined as a contest, exhibition or display which combines boxing or wrestling with one or more martial arts – are licensable as a boxing or wrestling entertainment rather than an indoor sporting event.
- **Live music:** no licence permission is required for:
 - o a performance of unamplified live music between 08.00 and 23.00 on any day, on any premises.
 - o a performance of amplified live music between 08.00 and 23.00 on any day on premises authorised to sell alcohol for consumption on those premises, provided that the audience does not exceed 500.
 - o a performance of amplified live music between 08.00 and 23.00 on any day, in a workplace that is not licensed to sell alcohol on those premises, provided that the audience does not exceed 500.
 - o a performance of amplified live music between 08.00 and 23.00 on any day, in a church hall, village hall, community hall, or other similar community premises, that is not licensed by a premises licence to sell alcohol, provided that (a) the audience does not exceed 500, and (b) the organiser gets consent for the performance from a person who is responsible for the premises.
 - o a performance of amplified live music between 08.00 and 23.00 on any day, at the non-residential premises of (i) a local authority, or (ii) a school, or (iii) a hospital, provided that (a) the audience does not exceed 500, and (b) the organiser gets consent for the performance on the relevant premises from: (i) the local authority concerned, or (ii) the school or (iii) the health care provider for the hospital.
- **Recorded Music:** no licence permission is required for:
 - o any playing of recorded music between 08.00 and 23.00 on any day on premises authorised to sell alcohol for consumption on those premises, provided that the audience does not exceed 500.
 - o any playing of recorded music between 08.00 and 23.00 on any day, in a church hall, village hall, community hall, or other similar community premises, that is not licensed by a premises licence to sell alcohol, provided that (a) the audience does not exceed 500, and (b) the organiser gets consent for the performance from a person who is responsible for the premises.
 - o any playing of recorded music between 08.00 and 23.00 on any day, at the non-residential premises of (i) a local authority, or (ii) a school, or (iii) a hospital, provided that (a) the audience does not exceed 500, and (b) the organiser gets consent for the performance on the relevant premises from: (i) the local authority concerned, or (ii) the school proprietor or (iii) the health care provider for the hospital.

Continued from previous page...

- Dance: no licence is required for performances between 08.00 and 23.00 on any day, provided that the audience does not exceed 500. However, a performance which amounts to adult entertainment remains licensable.
- Cross activity exemptions: no licence is required between 08.00 and 23.00 on any day, with no limit on audience size for:
 - o any entertainment taking place on the premises of the local authority where the entertainment is provided by or on behalf of the local authority;
 - o any entertainment taking place on the hospital premises of the health care provider where the entertainment is provided by or on behalf of the health care provider;
 - o any entertainment taking place on the premises of the school where the entertainment is provided by or on behalf of the school proprietor; and
 - o any entertainment (excluding films and a boxing or wrestling entertainment) taking place at a travelling circus, provided that (a) it takes place within a moveable structure that accommodates the audience, and (b) that the travelling circus has not been located on the same site for more than 28 consecutive days.

Section 18 of 18

PAYMENT DETAILS

This fee must be paid to the authority. If you complete the application online, you must pay it by debit or credit card.

Fees are dependent on the business rate band of the premises. Further information is provided at the link below: <https://www.leicester.gov.uk/business/licences-and-permits/entertainment-food-and-drink-licensing/alcohol-entertainment-and-late-night-refreshment/policy-and-guidance/>

* Fee amount (£)

180.00

ATTACHMENTS

AUTHORITY POSTAL ADDRESS

Address

Building number or name

Street

District

City or town

County or administrative area

Postcode

Country

United Kingdom

DECLARATION

I/WE UNDERSTAND THAT IT IS AN OFFENCE, UNDER SECTION 158 OF THE LICENSING ACT 2003, TO MAKE A FALSE
* STATEMENT IN OR IN CONNECTION WITH THIS APPLICATION. THOSE WHO MAKE A FALSE STATEMENT MAY BE LIABLE ON SUMMARY CONVICTION TO A FINE OF ANY AMOUNT.

[Applicable to individual applicants only, including those in a partnership which is not a limited liability partnership]: I
* understand I am not entitled to be issued with a licence if I do not have the entitlement to live and work in the UK (or if I am subject to a condition preventing me from doing work relating to the carrying on of a licensable activity) and that my licence will become invalid if I cease to be entitled to live and work in the UK (please read guidance note 15).

☐ Ticking this box indicates you have read and understood the above declaration

Continued from previous page...

This section should be completed by the applicant, unless you answered "Yes" to the question "Are you an agent acting on behalf of the applicant?"

* Full name

J Kakmeni

* Capacity

Date (dd/mm/yyyy)

21/03/2025

Add another signatory

Once you're finished you need to do the following:

1. Save this form to your computer by clicking file/save as...
2. Go back to <https://www.gov.uk/apply-for-a-licence/premises-licence/leicester/change-1> to upload this file and continue with your application.

Don't forget to make sure you have all your supporting documentation to hand.

IT IS AN OFFENCE, UNDER SECTION 158 OF THE LICENSING ACT 2003, TO MAKE A FALSE STATEMENT IN OR IN CONNECTION WITH THIS APPLICATION. THOSE WHO MAKE A FALSE STATEMENT MAY BE LIABLE ON SUMMARY CONVICTION TO A FINE OF ANY AMOUNT.

Licensing Act 2003
Premises Licence

LEIPRM0381



Licensing
Leicester City Council
City Hall
115 Charles Street
Leicester
LE1 1FZ

(0116) 4543030
licensing@leicester.gov.uk

Part 1 - Premises Details

POSTAL ADDRESS OF PREMISES, OR IF NONE, ORDNANCE SURVEY MAP REFERENCE OR DESCRIPTION		
Alino African Bar & Restaurant		
11 Narborough Road, Leicester, LE3 OLE.		Telephone 0116 255 9789

WHERE THE LICENCE IS TIME LIMITED THE DATES		
Not applicable	Expires	no expiry

LICENSABLE ACTIVITIES AUTHORISED BY THE LICENCE	
<ul style="list-style-type: none">- an exhibition of a film- a performance of live music- any playing of recorded music- a performance of dance- entertainment of a similar description to that falling within a performance of live music, any playing of recorded music or a performance of dance- the supply of alcohol	

THE TIMES THE LICENCE AUTHORISES THE CARRYING OUT OF LICENSABLE ACTIVITIES			
Activity (and Area if applicable)	Description	Time From	Time To
B. Exhibition of films (Indoors)	Mon-Thur	10:00am	Midnight
	Fri-Sun	10:00am	1:00am
E. Performance of live music (Indoors)	Mon-Thur	10:00am	Midnight
	Friday	10:00am	1:00am
	Sat-Sun	Noon	1:00am
F. Playing of recorded music (Indoors)	Mon-Thur	10:00am	Midnight
	Fri-Sun	10:00am	1:00am
G. Performance of dance (Indoors)	Mon-Thur	10:00am	Midnight
	Fri-Sun	10:00am	1:00am
H. Entertainment of a similar description to that falling within E, F, or G (Indoors)	Mon-Thur	10:00am	Midnight
	Fri-Sun	10:00am	1:00am
J. Supply of alcohol for consumption ON and OFF the premises	Mon-Thur	10:00am	Midnight
	Fri-Sun	10:00am	1:00am

Licensing Act 2003
Premises Licence

LEIPRM0381



Licensing
Leicester City Council
City Hall
115 Charles Street
Leicester
LE1 1FZ
(0116) 4543030
licensing@leicester.gov.uk

THE OPENING HOURS OF THE PREMISES

Description	Time From	Time To
Unrestricted		

WHERE THE LICENCE AUTHORISES SUPPLIES OF ALCOHOL WHETHER THESE ARE ON AND / OR OFF SUPPLIES

- J. Supply of alcohol for consumption ON and OFF the premises

Part 2

NAME, (REGISTERED) ADDRESS, TELEPHONE NUMBER AND EMAIL (WHERE RELEVANT) OF HOLDER OF PREMISES LICENCE

Jean-Alain Kakmeni 30 Strensall Road, Leicester, LE2 9FT.

REGISTERED NUMBER OF HOLDER, FOR EXAMPLE COMPANY NUMBER, CHARITY NUMBER (WHERE APPLICABLE)

NAME, ADDRESS AND TELEPHONE NUMBER OF DESIGNATED PREMISES SUPERVISOR WHERE THE PREMISES LICENCE AUTHORISES THE SUPPLY OF ALCOHOL

Alvine Nadege KOUAYA TCHEGA

PERSONAL LICENCE NUMBER AND ISSUING AUTHORITY OF PERSONAL LICENCE HELD BY DESIGNATED PREMISES SUPERVISOR WHERE THE PREMISES LICENCE AUTHORISES FOR THE SUPPLY OF ALCOHOL

Licence No. LEIPRS4935 Issued by Leicester



Licensing Act 2003

Premises Licence

LEIPRM0381



Leicester
City Council

Licensing
Leicester City Council
City Hall
115 Charles Street
Leicester
LE1 1FZ

(0116) 4543030
licensing@leicester.gov.uk

ANNEXES

Annex 1 - Mandatory conditions

No supply of alcohol may be made under the premises licence -

- a) at a time when there is no designated premises supervisor in respect of the premises licence, or
- b) at a time when the designated premises supervisor does not hold a personal licence or his personal licence is suspended.

Every supply of alcohol under the premises licence must be made or authorised by a person who holds a personal licence.

The responsible person must ensure that staff on relevant premises do not carry out, arrange or participate in any irresponsible promotions in relation to the premises. In this paragraph, an irresponsible promotion means any one or more of the following activities, or substantially similar activities, carried on for the purpose of encouraging the sale or supply of alcohol for consumption on the premises-

- a) games or other activities which require or encourage, or are designed to require or encourage, individuals to-
 - i) drink a quantity of alcohol within a time limit (other than to drink alcohol sold or supplied on the premises before the cessation of the period in which the responsible person is authorised to sell or supplied alcohol), or
 - ii) drink as much alcohol as possible (whether within a time limit or otherwise);
- b) provision of unlimited or unspecified quantities of alcohol free or for a fixed or discounted fee to the public or to a group defined by a particular characteristic in a manner which carries a significant risk of undermining a licensing objective;
- c) provision of free or discounted alcohol or any other thing as a prize to encourage or reward the purchase and consumption of alcohol over a period of 24 hours or less in a manner which carries a significant risk of undermining a licensing objective;
- d) selling or supplying alcohol in association with promotional posters or flyers on, or in the vicinity of, the premises which can reasonably be considered to condone, encourage or glamorise anti-social behaviour or to refer to the effects of drunkenness in any favourable manner;
- e) dispensing alcohol directly by one person into the mouth of another (other than where that other person is unable to drink without assistance by reason of a disability).

The responsible person must ensure that free potable water is provided on request to customers where it is reasonably available.

The premises licence holder or club premises certificate holder must ensure that an age verification policy is adopted in respect of the premises in relation to the sale or supply of alcohol.

The designated premises supervisor in relation to the premises licence must ensure that the supply of alcohol at the premises is carried on in accordance with the age verification policy.

The policy must require individuals who appear to the responsible person to be under 18 years of age (or such older age as may be specified in the policy) to produce on request, before being served alcohol, identification bearing their photograph, date of birth and either-

- a) a holographic mark, or
- b) an ultraviolet feature.

The responsible person shall ensure that-

- a) where any of the following alcoholic drinks is sold or supplied for consumption on the premises (other than alcoholic drinks sold or supplied having been made up in advance ready for sale or supply in a securely closed container) it is available to customers in the following measures-
 - i) beer or cider: ½ pint;
 - ii) gin, rum, vodka or whisky: 25 ml or 35 ml; and
 - iii) still wine in a glass: 125 ml;
- b) these measures are displayed in a menu, price list or other printed material which is available to customers on the premises; and
- c) where a customer does not in relation to a sale of alcohol specify the quantity of alcohol to be sold, the customer is made aware that these measures are available.

A relevant person shall ensure that no alcohol is sold or supplied for consumption on or off the premises for a price which is less than the permitted price.

Annex 2 - Conditions consistent with the operating schedule

The restrictions in this Annex do not prohibit any sale, supply or consumption of alcohol previously permitted by the Licensing Act 1964.

Alcohol shall not be sold or supplied unless it is paid for before or at the time when it is sold or supplied, except alcohol sold or supplied with and for consumption at a meal supplied at the same time, consumed with the meal and paid for together with the meal.

No person under fourteen shall be in the bar of the licensed premises during the hours that the premises is licensed for the sale of alcohol, except as



Licensing Act 2003
Premises Licence

LEIPRM0381

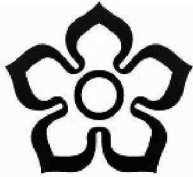

Leicester
City Council

Licensing
Leicester City Council
City Hall
115 Charles Street
Leicester
LE1 1FZ

(0116) 4543030
licensing@leicester.gov.uk

ANNEXES continued ...

previously permitted by the Licensing Act 1964.

Licensable activities may continue between the end of the hours permitted by the licence on New Years Eve and the start of the hours permitted by the licence on New Years Day.

The licence holder will ensure that CCTV is installed following advice from the Leicestershire Constabulary Crime Reduction Officer and maintained in accordance with the Information Commissioner's CCTV Code of Practice.

Annex 3 - Conditions attached after a hearing by the Licensing Authority

None





Leicester
City Council

Licensing
Leicester City Council
City Hall
115 Charles Street
Leicester
LE1 1FZ

(0116) 4543030
licensing@leicester.gov.uk

Premises Details

POSTAL ADDRESS OF PREMISES, OR IF NONE, ORDNANCE SURVEY MAP REFERENCE OR DESCRIPTION

Alino African Bar & Restaurant

11 Narborough Road, Leicester, LE3 OLE.

Telephone 0116 255 9789

WHERE THE LICENCE IS TIME LIMITED THE DATES

Not applicable

LICENSABLE ACTIVITIES AUTHORISED BY THE LICENCE

- an exhibition of a film
- a performance of live music
- any playing of recorded music
- a performance of dance
- entertainment of a similar description to that falling within a performance of live music, any playing of recorded music or a performance of dance
- the supply of alcohol

THE TIMES THE LICENCE AUTHORISES THE CARRYING OUT OF LICENSABLE ACTIVITIES

Activity (and Area if applicable)	Description	Time From	Time To
B. Exhibition of films (Indoors)	Mon-Thur	10:00am	Midnight
	Fri-Sun	10:00am	1:00am
E. Performance of live music (Indoors)	Mon-Thur	10:00am	Midnight
	Friday	10:00am	1:00am
	Sat-Sun	Noon	1:00am
F. Playing of recorded music (Indoors)	Mon-Thur	10:00am	Midnight
	Fri-Sun	10:00am	1:00am
G. Performance of dance (Indoors)	Mon-Thur	10:00am	Midnight
	Fri-Sun	10:00am	1:00am
H. Entertainment of a similar description to that falling within E, F, or G (Indoors)	Mon-Thur	10:00am	Midnight
	Fri-Sun	10:00am	1:00am
J. Supply of alcohol for consumption ON and OFF the premises	Mon-Thur	10:00am	Midnight
	Fri-Sun	10:00am	1:00am



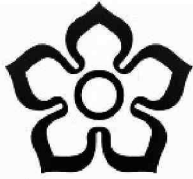

Leicester
City Council

Licensing
Leicester City Council
City Hall
115 Charles Street
Leicester
LE1 1FZ

(0116) 4543030
licensing@leicester.gov.uk

THE OPENING HOURS OF THE PREMISES

Description	Time From	Time To
Unrestricted		

WHERE THE LICENCE AUTHORISES SUPPLIES OF ALCOHOL WHETHER THESE ARE ON AND / OR OFF SUPPLIES

- J. Supply of alcohol for consumption ON and OFF the premises

NAME, (REGISTERED) ADDRESS OF HOLDER OF PREMISES LICENCE

Jean-Alain Kakmeni

30 Strensall Road, Leicester, LE2 9FT.

REGISTERED NUMBER OF HOLDER, FOR EXAMPLE COMPANY NUMBER, CHARITY NUMBER (WHERE APPLICABLE)**NAME OF DESIGNATED PREMISES SUPERVISOR WHERE THE PREMISES LICENCE AUTHORISES THE SUPPLY OF ALCOHOL**

Alvine Nadege KOUAYA TCHEGA

STATE WHETHER ACCESS TO THE PREMISES BY CHILDREN IS RESTRICTED OR PROHIBITED

Restricted





Appendix C1

Leicestershire Police

Licensing Act 2003

Representation in respect of a major variation application

Details of person or body making representation	
Your Name:	PC Jefferson Pritchard
Your Address:	Mansfield House, 74 Belgrave Gate, Leicester LE1 3GG

Details of premises representation is about	
Name of Premises:	Alino
Address of premises:	11 Narborough Road Leicester LE3 0LE
Application No. (if known)	

Please tick one or more of the licensing objectives that your representation relates to:	
Prevention of crime and disorder	X
Public Safety	X
Prevention of public nuisance	X
Protection of children from harm	X

Please summarise your concerns about this application:
<p>I write in my capacity as Leicester City Centre's alcohol licensing officer for Leicestershire Police, with delegated authority from the Chief Constable.</p> <p>My representation to this major variation application is based upon the licensing objectives, as per the Licensing Act 2003.</p> <p>The application in its current format would undermine all four licensing objectives if granted. Those being:</p> <p>(1) The prevention of crime and disorder. (2) Public Safety.</p>

- (3) The prevention of public nuisance.
- (4) The protection of children from harm.

The premises is located on Narborough Road. Narborough Road acts as an arterial route linking the city centre with Fosse Park and junction 21 of the M1 motorway.

The area consists of high-density residential housing along the numerous side streets, with retail/commercial and licensed premises on the ground floor along Narborough Road itself. Most of the ground floor properties have residential flats directly above.

Several other licensed premises which provide alcohol for consumption on the premises are located nearby.

The premises is located within an “area of special interest” as referred to in Leicester City Council’s Statement of Licensing Policy dated 2022-2027. The application makes no reference to this policy, so it is unclear if the applicant has considered this.

The venues premises licence (LEIPRM0381) was granted in 2009, with the applicant appointed as the premises licence holder in 2014.

In 2022, the premises came to the attention of Leicestershire Police Licensing department requiring intervention.

In September 2024, Leicestershire Police and Leicester City Council Licensing Enforcement visited the premises, Despite being closed to the public at the time of the visit, as the premises was undergoing a major refurbishment, it was noted that significant alterations had been made to the internal layout of the premises.

The applicant was informed a minor variation would be required given the layout changes.

In December 2024, the police re-iterated the previous about a minor variation and the applicant stated this would be completed. To date, the police are unaware of a minor variation application given the significant alterations to the internal layout of the venue and that the premises continue to trade/open to the public.

The venues existing Leicester City Council premises licence permits the following licensable activities and operating hours:

- **Unrestricted opening hours to the public.**
- **Supply of alcohol for consumption on and off the premises:**
Monday to Thursday from 10am until midnight.
Friday to Sunday from 10am until 1am.
- **Playing of recorded music, performance of dance, entertainment of a similar nature and exhibition of films (indoors only):**
Monday to Thursday from 10am until midnight.
Friday to Sunday from 10am until 1am.

- **The performance of live music (indoors only):**

Monday to Thursday from 10am until midnight.

Friday from 10am until 1am.

Saturday & Sunday from 12 noon until 1am.

(No seasonal variations and late-night refreshments provision)

This major variation application proposes to increase the hours permitted for certain licensable activities on specific days of the week. Those being:

- **Supply of alcohol for consumption ON the premises only** on Friday & Saturday from 10am until 3am.

Therefore, an additional two hours on Friday & Saturday.

- Including seasonal variations on 25th December and 1st January until 3am.

- **The playing of recorded music and live music on Friday & Saturday (indoors only)** from 10am until 3am.

Therefore, an additional two hours on Friday & Saturday.

- Including seasonal variations on 25th December and 1st January until 3am.

- **Late Night Refreshments (indoors only) on Friday & Saturday** from 11pm until 3am.

Therefore, a new licensable activity.

- Including seasonal variations on 25th December and 1st January until 3am.

The application refers to several ways to promote the licensing objectives but is vague about exactly how this will be achieved. The applicant has hinted at some licence condition, but any such conditions need to be precise and enforceable for them to be valid. An example of this, states security personal will be employed at the premises on Friday and Saturday. However, it does not refer to what time they will be deployed which would suggest they would be deployed from 10am until 3am, which I suspect is not what is intended.

The Narborough Road area/corridor is a challenging environment for operators and more so those who operate in the night-time economy and who also supply alcohol for consumption on the premises.

Leicestershire Police has recorded some crime and disorder associated to the premises in the last year (closed for a period in 2024 for refurbishment), including in 2025.

Unfortunately, alcohol related violent crime, disorder and anti-social behaviour does rise in the night-time economy (10pm-7am) and this is not different along Narborough Road. Therefore, there is a real possibility that revellers already under the influence of alcohol will attend the venue in the early hours of the morning to source more alcohol.

Leicestershire Police respectfully requests the application is refused as it fails to promote all four licensing objectives.

PC2093 Jefferson Pritchard
Leicestershire Police
Wednesday 2nd April 2025



Licensing Act 2003 - Representation in respect of Premises Licence

Details of person or body making representation	
Your Name:	Gary Geldard
Your Address:	Noise and Pollution Control Team Floor 1 City Hall 115 Charles Street Leicester LE1 1FZ

Details of premises representation is about	
Name of Premises:	Alino African Bar and Restaurant
Address of premises:	11 Narborough Road Leicester LE3 0LE
Application No. (if known)	172933 LEIPRM0381

Please tick one or more of the licensing objectives that your representation relates to:	
Prevention of crime and disorder	<input type="checkbox"/> No
Public Safety	<input type="checkbox"/> No
Prevention of public nuisance	<input type="checkbox"/> Yes
Protection of children from harm	<input type="checkbox"/> No

Please summarise your concerns about this application:

The immediate area is a busy part of the city with a mixed use of mainly retail, food outlets and bars.

However, there is a first floor flat above the premises and several more adjoining on either side. There are also several residential properties opposite on Ruding Road.

The application is to extend the hours of licensable activities from:

- Midnight on Monday-Thursday
 - 0100 Hrs. on Friday -Sunday
- to 0300 Hrs. daily.

The existing licensable activities include:

- indoor playing of recorded music
- indoor performance of live music
- indoor performance of dance
- supply of alcohol.

During the daytime, road traffic, commercial activity and on-street activity are the dominant noise sources in the locality. However, later in the evening and into the early hours of the morning traffic noise and street noise noticeably reduces.

I am concerned that allowing the premises to operate such long hours will increase the likelihood of noise complaints and cause disturbance to residents by customers visiting the premises throughout the night and particularly into the early hours of the morning. There is also the likelihood of noise disturbance from deliveries and staff activities.

I will attempt to contact the applicant regarding my concerns and to discuss any possible noise limiting arrangements.

Please give further details of why you believe this application will have an adverse effect on the licensing objectives.

Occupants of adjoining and nearby residential properties could be adversely affected by noise from activity inside the premises, particularly when windows and doors are open.

Occupants of adjoining and nearby residential properties could be adversely affected by noise from patrons gathering outside the front of the premises, including after closing time.

Occupants of adjoining and nearby residential properties could be adversely affected by noise from deliveries and staff activities.

Return your completed form to:

By Email:

licensing@leicester.gov.uk

Jean Alain Kakmeni
11 Narborough Road
Leicester
LE3 0LE

Licensing Team
Leicester City Council
91 Granby Street
Leicester
LE1 6ZG

Licensing Act 2003 – Application for variation of a premises licence
LEIPRM0381 Alino African Bar and Restaurant, 11 Narborough Road,
Leicester.

I Jean Alain Kakmeni the applicant for the above variation of a Premises Licence, hereby agree to the following conditions being added to any premises licence granted in response to the above application, in respect to prevention of public nuisance.

- **Live or recorded, amplified music shall not be played outside of 1000-0100 Hrs. Sunday to Thursday and 1000-0300 Hrs. Friday and Saturday.**
- **All external doors and windows (including skylights) shall be kept closed, other than for access and egress, in all rooms when events involving amplified music or voice are taking place.**
- **There shall be no use of the outside area for the playing of live nor recorded, amplified music or voice.**
- **Disposal of waste bottles into external receptacles (where noise would be audible to occupants of nearby properties), shall not take place between 2100-0900 Hrs.**
- **Signage to be prominently displayed on site reminding patrons to keep noise to a minimum when using the outside area and when exiting the premises.**

Signed Jean Alain Kakmeni

Dated.....



Representation in respect of a Variation Application

Licensing Act 2003

Details of person or body making representation:	
Your Name:	Bobby Smiljanic
Your position/role:	Licensing Enforcement Manager

Details of premises representation is about:	
Name of Premises:	Alino Ltd
Address of premises:	11 Narborough Road Leicester LE3 0LE
Application No. (if known)	172933

Please tick one or more of the licensing objectives that your representation relates to:	
Prevention of Crime and Disorder	<input checked="" type="checkbox"/>
Public Safety	<input checked="" type="checkbox"/>
Prevention of Public Nuisance	<input checked="" type="checkbox"/>
Protection of Children from Harm	<input type="checkbox"/>

Authority Declarations:
<p>I write in my capacity as Licensing Enforcement Manager for Leicester City Council Licensing Authority on the authority delegated to me.</p> <p>Please take notice that I am satisfied that allowing the premises to be used in accordance with the application would undermine the above stated Licensing Objectives and as such submit our representations.</p>

Representations:
<p>We would like to submit our representations for this variation application based upon the above stated licensing objectives.</p> <p>The application is for the variation of Premises Licence LEIPRM0381 for the following licensable activities:</p>

- Provision of Live Music (indoors) from 10:00hrs to 03:00hrs Friday and Saturday. Seasonal variations have been requested on Christmas Eve and New Years Eve until 04:00hrs.
- Provision of Recorded Music (indoors) from 10:00hrs to 03:00hrs Friday and Saturday. Seasonal variations have been requested on Christmas Eve and New Years Eve until 04:00hrs.
- Provision of Late Night Refreshment (indoors) from 10:00hrs to 03:00hrs Friday and Saturday. Seasonal variations have been requested on Christmas Eve and New Years Eve until 03:00hrs.
- The supply of alcohol on the premises has been requested from 10:00hrs to 03:00hrs Friday and Saturday. Seasonal variations have been requested on Christmas Eve and New Years Eve until 03:00hrs.
- The premises currently has unrestricted opening hours, but seasonal variations have been requested for Christmas Eve and New Years Eve until 04:00hrs.

The premises is currently licenced for the following activities:

- Exhibition of films (Indoors) Monday – Thursday 10:00hrs to 00:00hrs
Friday – Sunday 10:00hrs to 01:00hrs
- Performance of live music (Indoors) Monday – Thursday 10:00hrs to 00:00hrs
Friday 10:00hrs to 01:00hrs
Saturday – Sunday 12:00hrs to 01:00hrs
- Playing of recorded music (Indoors) Monday – Thursday 10:00hrs to 00:00hrs
Friday – Sunday 10:00hrs to 01:00hrs
- Performance of dance (Indoors) Monday – Thursday 10:00hrs to 00:00hrs
Friday – Sunday 10:00hrs to 01:00hrs
- Entertainment of a similar description to that falling within E,F or G (Indoors)
Monday – Thursday 10:00hrs to 00:00hrs
Friday – Sunday 10:00hrs to 01:00hrs
- The supply of alcohol for consumption on and off the premises
Monday – Thursday 10:00hrs to 00:00hrs
Friday – Sunday 10:00hrs to 01:00hrs
- The premises opening hours are unrestricted.

The premises is a bar and restaurant located on the ground floor of 11 Narborough Road a busy area just outside the city centre in the Westcotes ward. The area consists of a mixture of bars and restaurants, drinking establishments, commercial businesses and residential dwellings.

The premises also holds a current Pavement Cafe Licence LEISC6136.

There are a variety of licensed premises in the vicinity including off licences, late night refreshment premises and bars, many of which are open throughout the nighttime economy.

The proposed area to be licensed is on the ground floor using the front door for both access and egress.

The shop comprises one property as part of a terrace of buildings with other businesses either side, and living accommodation upstairs.

Ms Elizabeth Arculus, Licensing Officer and Miss Minaxi Patel, Licensing Enforcement Officer from the Licensing Team at Leicester City Council visited the premises at 11.00hrs on Tuesday 8th April 2025. Ms Arculus had emailed the applicant Mr Jean Alain Kakmeni several times to request a meeting. As there was no response, Ms Arculus contacted the Designated Premises Supervisor Alvine Kouaya Tchega to arrange the meeting. Mr Kakmeni was asked to attend, but unfortunately Mrs Kouaya Tchega confirmed that Mr Kakmeni was unavailable.

11 Narborough Road falls within a designated Area of Special Interest and Consultation under Leicester City Councils Licensing Policy under Section 8 - [licensing-policy-2022-2027.pdf \(leicester.gov.uk\)](#).

Attempts have not been made to address the policy or any of the general concerns.

It is imperative that all applicants fully consider the environmental factors of the area in which they are applying. Section 182 guidance states that applicants should proactively engage with the responsible authorities to ensure that a premises and their management uphold the licensing objectives.

Mrs Kouaya Tchega was unaware of this policy when it was raised by the Licensing Officer at the start of the meeting.

The purpose of the facility was explained to them. They discussed the general operation of the premises and Mrs Kouaya Tchega was asked to explain some of the methods to counter some of the concerns that they raised.

The application refers to a recent major refurbishment which included some extensive remodelling of the premises and full sound insulation. Leicestershire Police and Licensing Enforcement visited the premises on 20th September 2024 and it was noted that the premises was closed for a major refurbishment. Mr Kakmeni and Mrs Kouaya Tchega were advised by Licensing Enforcement Officers to contact the Licensing Department as a variation would be required due to the change of layout. However, Mrs Kouaya Tchega explained that only planning had been informed about this change. Therefore, a breach of the licence has already taken place.

In addition, a Temporary Event Notice was submitted for 1st December 2024 but was refused by the Licensing Authority as it was a late submission. However a breach of the licence conditions was observed by Licensing Enforcement Officers that evening after 01:00hrs and the applicant was spoken to by the officers at 01:25hrs.

Mrs Kouaya Tchega stated that the premises employed an SIA registered security guard on Friday and Saturday from 22:00hrs to the close time.

The capacity of the venue was discussed, but Mrs Kouaya Tchega was unsure about this. The capacity of the venue is usually decided by the Fire Risk Assessment and when Ms Arculus asked Mrs Kouaya Tchega where the fire risk assessment was, she was unsure as to whether or not they had one.

The premises also did not have a refusals/incident log on the premises or any training records for staff.

There were internal and external CCTV cameras installed at the premises with good coverage.

Mrs Kouaya Tchega understood that staff needed to ask for ID in line with the Challenge 25 procedure, which ID to look for, and how to check it was genuine. However there were no Challenge 25 posters on display at the venue.

The Licensing Authority do have concerns about the premises and the effects the extended hours may have on the local community, both business and residential. This relates to the detail of the operating schedule that has been applied for.

The operating schedule does lay out some of the intentions of the applicant however it is loose in outlining specifically how they would uphold the licensing objectives.

The Licensing Authority believe that the application fails to promote three of the licensing objectives and therefore respectfully requests that the application be refused.

However, if the committee elected to grant the licence, the Licensing Authority respectfully requests that the committee considers attaching the following licence conditions in order to promote the licensing objectives.

Conditions Details:

We believe the below additions/amendments of conditions in full, which we believe are reasonable, proportionate and enforceable, may assist the Licence Holder in upholding the licensing objectives.

We have detailed, for clarity, those that

- (a) We believe should be replaced from the applied operating schedule with our proposed wording
- (b) Those to be removed from the operating schedule and;
- (c) Those that are in addition.

Any wording on the operating schedule that is not detailed below to remain on any licence

(a) Conditions to be replaced from Operating Schedule

Wording contained within the applied operating schedule as copied below be replaced with Requested Condition/s:

Operating Schedule Wording:

- *CCTV is been install and maintain to deter crime and provide evidence.*
- *In house security personnel with up to date SIA license.*
- *We have robust age verification procedures in place to prevent underage drinking and entry.*

To be replaced with:

- The licence holder will ensure a high definition, colour HD CCTV camera system is installed, operational and recording whilst the premises is open to the public. The system must permit the identification of individual(s) in all lighting conditions.
- CCTV cameras must cover all areas that the public have access to, including the entrance, exit and pavement area immediately outside the premises.
- CCTV system images must be securely stored, display an accurate date/time stamp and retained for a minimum of 31 days.
- The licence holder will ensure that there is always a member of staff trained and available to download CCTV images/ footage immediately if requested by the police or the Licensing Authority.
- The licence holder will employ a minimum of two Security Industry Authority (SIA) front line door supervisors at the premises on Friday, Saturday and at seasonal events from 10pm until all customers have left the premises when both the ground floor and basement area is being used by customers.
- The licence holder will ensure all Security Industry Authority (SIA) door supervisor(s) used at the premises record their full name, full SIA registration number and the dates/time deployed at the premises. A record must be kept on the premises for six months and made available for inspection to an officer from a responsible authority upon request.
- A Challenge 25 policy will be adopted with the only acceptable proof of age identification consisting of a current passport, photo card driving licence or identification carrying a PASS logo. A training record must be kept on the premises, retained for 12 months from

the date of the incident and produced to an officer from a responsible authority upon request.
--

(b) Conditions to be removed from Operating Schedule
<i>Wording contained within the applied operating schedule as copied below be <u>removed</u>:</i>
Operating Schedule Wording to be removed: N/A

(c) Requested Additional Conditions
<i>Condition/s wording below to be added in full to any granted licence:</i>
<ul style="list-style-type: none"> • An incident and refusals log will be kept on the premises and retained for a period of 12 months from the date of the incident. The log will be made immediately available for inspection on request of an officer from a responsible authority. • The licence holder will ensure that a full fire risk assessment will be conducted and reviewed and implemented in line with Fire Safety Legislation annually. • There will be regular safety checks of areas such as entrances/exits recorded in a logbook which will be kept on the premises and immediately available upon request from any authority officers. • Bins and bottles must be emptied between 07:00hrs and 22:00hrs. • The licence holder shall take reasonable steps to prevent public nuisance being caused by customers outside the premises by displaying prominent Quiet notices requesting customers respect the needs of local residents. • The Licence is subject to Leicester City Council's Standard Conditions for Places of Public Entertainment, published on the Licensing Authority's website www.leicester.gov.uk/licensing

Appendix:	
Appendix 1	N/A

Authority Signatures:
<p>Bobby Smiljanic Licensing Enforcement Manager Leicester City Council 15/04/2025</p> <p>Reporting Officer Elizabeth Arculus</p>

Licensing Authority Details:

Licensing Authority
Licensing Enforcement
York House
91 Granby Street
LE1 6FB

Tel: 0116 4540049

Email: licensingenforcement@leicester.gov.uk

www.leicester.gov.uk/licensing

Notice Sent to:

Please note that this representation has been sent to:

- (1) Licensing Authority Applications Team, Leicestershire Police Licensing, Noise Pollution Team, Leicestershire Fire & Rescue Service
- (2) Applicant and/or Agent

Agreement Notice Applicant (if applicable & only valid if signed)

Licensing Enforcement Agreement Confirmation (if applicable & only valid if signed)

CONDITIONS

CONDITIONS CONSISTENT WITH THE OPERATING SCHEDULE

In order to help the police fighting crime, we have upgraded our CCTV system to an ultimate 4K 30 days recording covering all angle. We currently have a permanent door supervisor Friday and Saturday.

Our Staff are trained to identify and prevent potential issues like signs of intoxication and dealing with disruptive customers CCTV has been installed and maintained to deter crime and provide evidence. In house security personnel with up to date SIA license.

We have fire extinguishers, fire exits, and emergency lighting in place and are regularly Maintained. We have a first aid box in place.

There are measures to ensure the premises do not become overcrowded by insuring head count.

Accessibility:

The premises are accessible for people with disabilities and that emergency exits are unobstructed.

We control noise levels by limiting the decibel of our sound system, to prevent disturbance to residents and neighbours.

Our premises is fully sound proof;

We do our best to ensure the premises and surrounding area are kept clean and free from litter and debris. During busy hours outside we do our best to minimize potential nuisance issues, such as queuing or loitering.

We encourage our customers to park their vehicle on the side street to help the traffic flow around the premises to prevent congestion.

We have robust age verification procedures in place to prevent underage drinking and entry. Children under the age of 18 are NOT allow in our premises after 8pm. before this hour, they can only here under parental supervision.

We always ensure the premises are a safe and suitable environment for children, free from any potential hazards or risks. Our staff are trained on how to identify and deal with underage individuals, and on the importance of protecting children.

CONDITIONS CONSISTENT WITH THE NOISE TEAM REPRESENTATION/AGREEMENT

Live or recorded, amplified music shall not be played outside of
1000-0100 Hrs. Sunday to Thursday and
1000-0300 Hrs. Friday and Saturday.

All external doors and windows (including skylights) shall be kept closed, other than for access and egress, in all rooms when events involving amplified music or voice are taking place.

There shall be no use of the outside area for the playing of live nor recorded, amplified music or voice. Disposal of waste bottles into external receptacles (where noise would be audible to occupants of nearby properties), shall not take place between 2100-0900 Hrs.

Signage to be prominently displayed on site reminding patrons to keep noise to a minimum when using the outside area and when exiting the premises.

CONDITIONS CONSISTENT WITH LICENSING ENFORCEMENT REPRESENTATION

The licence holder will ensure a high definition, colour HD CCTV camera system is installed, operational and recording whilst the premises is open to the public. The system must permit the identification of individual(s) in all lighting conditions.

CCTV cameras must cover all areas that the public have access to, including the entrance, exit and pavement area immediately outside the premises.

CCTV system images must be securely stored, display an accurate date/time stamp and retained for a minimum of 31 days.

The licence holder will ensure that there is always a member of staff trained and available to download CCTV images/ footage immediately if requested by the police or the Licensing Authority.

The licence holder will employ a minimum of two Security Industry Authority (SIA) front line door supervisors at the premises on Friday, Saturday and at seasonal events from 10pm until all customers have left the premises when both the ground floor and basement area is being used by customers.

The licence holder will ensure all Security Industry Authority (SIA) door supervisor(s) used at the premises record their full name, full SIA registration number and the dates/time deployed at the premises. A record must be kept on the premises for six months and made available for inspection to an officer from a responsible authority upon request.

A Challenge 25 policy will be adopted with the only acceptable proof of age identification consisting of a current passport, photo card driving licence or identification carrying a PASS logo. A training record must be kept on the premises, retained for 12 months from the date of the incident and produced to an officer from a responsible authority upon request.

An incident and refusals log will be kept on the premises and retained for a period of 12 months from the date of the incident. The log will be made immediately available for inspection on request of an officer from a responsible authority.

The licence holder will ensure that a full fire risk assessment will be conducted and reviewed and implemented in line with Fire Safety Legislation annually.

There will be regular safety checks of areas such as entrances/exits recorded in a logbook which will be kept on the premises and immediately available upon request from any authority officers.

Bins and bottles must be emptied between 07:00hrs and 22:00hrs.

The licence holder shall take reasonable steps to prevent public nuisance being caused by customers outside the premises by displaying prominent Quiet notices requesting customers respect the needs of local residents.

The Licence is subject to Leicester City Council's Standard Conditions for Places of Public Entertainment, published on the Licensing Authority's website www.leicester.gov.uk/licensing

Application for a new premises licence

Licensing (Hearings) Sub-Committee

Decision to be taken by: Licensing (Hearings)
Sub-Committee

Decision to be taken on/Date of meeting: 12 May 2025

Lead director/officer: Bobby Smiljanic

Useful information

- Ward(s) affected: Westcotes
- Report author: Amy Day
- Author contact details: 0116 454 3054
- Report version number: 1

1. Summary

- 1.1 This report outlines an application under the Licensing Act 2003 for a new premises licence for Ranya Leicester Ltd, 24 Braunstone Gate, Leicester, LE3 5LG and summarises the representations received. It also highlights the licensing objectives and the relevant parts of both the statutory guidance and the Licensing Authority's Licensing Policy.

2. Determination to be made

- 2.1 Having considered the application and representation, Members must consider whether to
- Grant the licence without modification
 - Grant the licence subject to conditions
 - Exclude from the licence any of the licensable activities
 - Refuse to accept the proposed premises supervisor
 - Reject the application

3. Application and promotion of the licensing objectives

- 3.1 An application was received on 18 March 2025 from Ranya Leicester Ltd for a new premises licence for Ranya Leicester Ltd, 24 Braunstone Gate, Leicester. A copy of the application is attached at Appendix A.

- 3.2 The application is as follows:

Licensable activity	Proposed hours
Supply of Alcohol	Monday to Sunday 08.00 – 01.00
Opening hours	Monday to Sunday 08.00 – 01.00

- 3.3 The steps the applicant proposes to take to promote the licensing objectives are set out in the operating schedule (see section M of Appendix A).
- 3.4 In arriving at its decision on the application, the Licensing Authority's primary consideration must be the promotion of the licensing objectives.

3.5 Location Plan

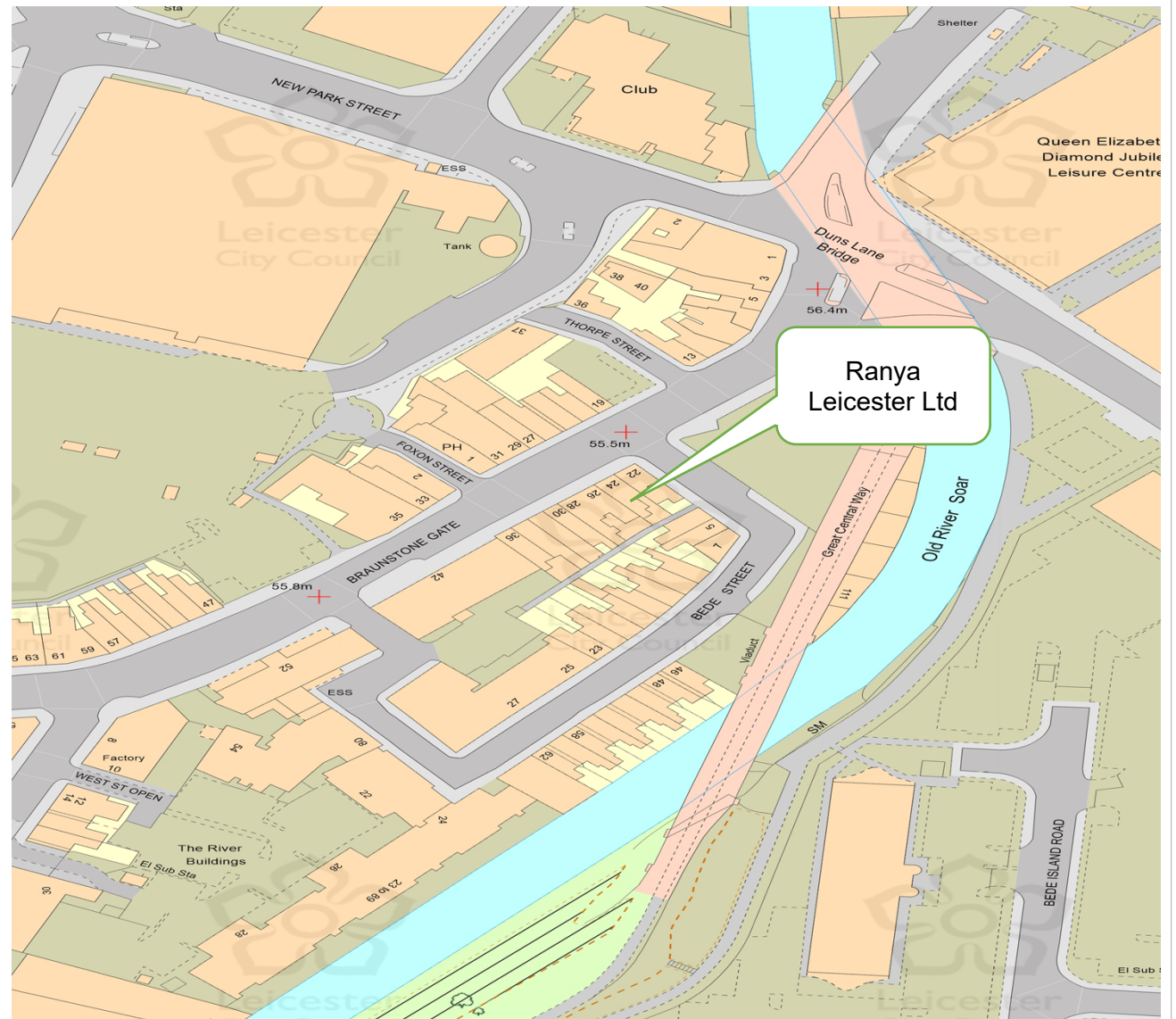

4. Representation

- 4.1 A representation was received on 10 April 2025 from the Police. The representation relates to the prevention of crime and disorder, the prevention of public nuisance, public safety and the protection of children from harm. The representee is concerned that the application is vague with regards to promoting the four licensing objectives and that the premises is in an area of special interest as per Leicester City Council's Statement of Licensing Policy and no reference has been made to this on the application. A copy of the representation is attached at Appendix B1.

5. Conditions

- 5.1 The conditions that are consistent with the application are attached at Appendix C.

6. Statutory guidance and statement of licensing policy

- 6.1 Any decision made by the Licensing Authority must be in accordance with the licensing objectives. In addition, the government has issued guidance under section 182 of the Licensing Act 2003. The parts of the guidance that are particularly relevant in this case are as follows:

Section	Heading
1.2 – 1.5	Licensing objectives and aims
1.15 – 1.16	General Principles
1.17	Each application on its own merits
2.1 – 2.6	Crime & Disorder
2.7 – 2.14	Public Safety
2.15 – 2.21	Public nuisance
2.22 – 2.31	Protection of children from harm
8.41 – 8.49	Steps to promote the licensing objectives
9.11 – 9.12	Role of responsible authorities
9.31 – 9.41	Hearings
9.42 – 9.44	Determining actions that are appropriate for the promotion of the licensing objectives
10.1 – 10.3	Conditions - general
10.8 – 10.9	Imposed conditions
10.10	Proportionality
10.13 - 10.15	Hours of trading
10.25 – 10.66	Mandatory conditions in relation to the supply of alcohol
13.10 – 13.11	Giving reasons for decisions
14.51 – 14.52	Licensing Hours

- 6.2 The relevant parts of the Licensing Authority's Statement of Licensing Policy are as follows:

Section	Heading
4	Promotion of the licensing objectives
5	General Principles
6	Premises Licences and Club Premises Certificates
8	Areas of Specific Interest and Consultation

7. Points for clarification

- 7.1 The applicant and the party / parties making the representation have been asked to clarify certain points at the hearing, as follows:

By the applicant

1. Whether the applicant considers that the concerns outlined in the representations are valid, and if not why not.
2. In the light of the representations made, whether the applicant wishes to propose any additional steps for the promotion of the licensing objectives.

By the party making the representation

1. Whether they have any additional information to support the representation they have made.
2. Whether there are any additional steps that could be taken which would be equally effective in the promotion of the licensing objectives.

8. Financial, legal, equalities, climate emergency and other implications

8.1 Financial implications

None.

8.2 Legal implications

Legal advice specific to the application will be provided at the meeting by Legal Officers.

8.3 Equalities implications

None.

8.4 Climate Emergency implications

There are unlikely to be any significant climate emergency implications directly associated with this report and the licensing process. Aidan Davis, Sustainability Officer, Ext 28 3384.

8.5 Other implications (You will need to have considered other implications in preparing this report. Please indicate which ones apply?)

None.

9. Background information and other papers:

None.

10. Summary of appendices:

Appendix A – Application

Appendix B – Representation

Appendix C – Conditions consistent with the application

11. Is this a private report (If so, please indicate the reasons and state why it is not in the public interest to be dealt with publicly)?

No.

12. Is this a “key decision”? If so, why?

No

Application for a premises licence to be granted under the Licensing Act 2003

Please read the following instructions first

Before completing this form please read the guidance notes at the end of the form. If you are completing this form by hand please write legibly in block capitals. In all cases ensure that your answers are inside the boxes and written in black ink. Use additional sheets if necessary.

You may wish to keep a copy of the completed form for your records.

I/We Ranya Leicester Ltd
(Insert name(s) of applicant)

apply for a premises licence under section 17 of the Licensing Act 2003 for the premises described in Part 1 below (the premises) and I/we are making this application to you as the relevant licensing authority in accordance with section 12 of the Licensing Act 2003

Part 1 – Premises details

Postal address of premises or, if none, ordnance survey map reference or description			
24 Braunstone Gate			
Post town	Leicester	Postcode	LE3 5LG

Telephone number at premises (if any)	N/A
Non-domestic rateable value of premises	£ 7,100

Part 2 - Applicant details

Please state whether you are applying for a premises licence as **appropriate** Please tick as

a)	an individual or individuals *			please complete section (A)
b)	a person other than an individual *			
	i	as a limited company/limited liability partnership	X	please complete section (B)
	ii	as a partnership (other than limited liability)		please complete section (B)
	iii	as an unincorporated association or		please complete section (B)
	iv	other (for example a statutory corporation)		please complete section (B)

c)	a recognised club		please complete section (B)
d)	a charity		please complete section (B)
e)	the proprietor of an educational establishment		please complete section (B)
f)	a health service body		please complete section (B)
g)	a person who is registered under Part 2 of the Care Standards Act 2000 (c14) in respect of an independent hospital in Wales		please complete section (B)
ga)	a person who is registered under Chapter 2 of Part 1 of the Health and Social Care Act 2008 (within the meaning of that Part) in an independent hospital in England		please complete section (B)
h)	the chief officer of police of a police force in England and Wales		please complete section (B)

* If you are applying as a person described in (a) or (b) please confirm (by ticking yes to one box below):

- I am carrying on or proposing to carry on a business which involves the use of the premises for licensable activities; or
- I am making the application pursuant to a
- statutory function or
- a function discharged by virtue of Her Majesty's prerogative

(A) individual applicants (fill in as applicable)

Mr	Mrs	Miss	Ms	Other Title (for example, Rev)	
Surname			First names		
Date of birth		I am 18 years old or over		Please tick yes	
Nationality					
Current residential address if different from premises address					
Post town				Postcode	
Daytime contact telephone number					
E-mail address (optional)					
Where applicable (if demonstrating a right to work via the Home Office online right to work checking service), the 'share code' provided to the applicant by that service (please see note 15 for information)					

--

Second individual applicant (if applicable)

Mr	Mrs	Miss	Ms	Other Title (for example, Rev)	
Surname			First names		
Date of birth or over		I am 18 years old		Please tick yes	
Nationality					
Current residential address if different from premises address					
Post town				Postcode	
Daytime contact telephone number					
E-mail address (optional)					
Where applicable (if demonstrating a right to work via the Home Office online right to work checking service), the 'share code' provided to the applicant by that service: (please see note 15 for information)					

(B) Other applicants

Please provide name and registered address of applicant in full. Where appropriate please give any registered number. In the case of a partnership or other joint venture (other than a body corporate), please give the name and address of each party concerned.

Name: Ranya Leicester Ltd
Address: 24 Braunstone Gate, Leicester, LE3 5LG

Registered number (where applicable) No. 16294140	
Description of applicant (for example, partnership, company, unincorporated association etc.) Limited Company	
Telephone number (if any)	
E-mail address (optional)	

Part 3 Operating Schedule

When do you want the premises licence to start?

DD	MM	YYYY
1	4	0 4 2 0 2 5

If you wish the licence to be valid only for a limited period, when do you want it to end?

DD	MM	YYYY

Please give a general description of the premises (please read guidance note 1)

Single room shop front with one access door to public (front of the building to main road).

Internally shopfitted for use as an Off License only with no provision for consumption On the premises.

Full coverage CCTV installed

If 5,000 or more people are expected to attend the premises at any one time, please state the number expected to attend.

N/A

What licensable activities do you intend to carry on from the premises?

(please see sections 1 and 14 and Schedules 1 and 2 to the Licensing Act 2003)

Provision of regulated entertainment (please read guidance note 2)	Please tick all that apply
a) plays (if ticking yes, fill in box A)	
b) films (if ticking yes, fill in box B)	
c) indoor sporting events (if ticking yes, fill in box C)	
d) boxing or wrestling entertainment (if ticking yes, fill in box D)	

e)	live music (if ticking yes, fill in box E)	
f)	recorded music (if ticking yes, fill in box F)	
g)	performances of dance (if ticking yes, fill in box G)	
h)	anything of a similar description to that falling within (e), (f) or (g) (if ticking yes, fill in box H)	

<u>Provision of late night refreshment</u> (if ticking yes, fill in box I)	
<u>Supply of alcohol</u> (if ticking yes, fill in box J)	X

In all cases complete boxes K, L and M

A

Plays Standard days and timings (please read guidance note 7)			Will the performance of a play take place indoors or outdoors or both – please tick (please read guidance note 3)	Indoors	
				Outdoors	
Day	Start	Finish		Both	
Mon			Please give further details here (please read guidance note 4)		
Tue					
Wed			State any seasonal variations for performing plays (please read guidance note 5)		
Thur					
Fri			Non standard timings. Where you intend to use the premises for the performance of plays at different times to those listed in the column on the left, please list (please read guidance note 6)		
Sat					
Sun					

B

Films Standard days and timings (please read guidance note 7)			Will the exhibition of films take place indoors or outdoors or both – please tick (please read guidance note 3)	Indoors	
				Outdoors	
Day	Start	Finish		Both	
Mon			Please give further details here (please read guidance note 4)		
Tue					
Wed			State any seasonal variations for the exhibition of films (please read guidance note 5)		
Thur					
Fri			Non standard timings. Where you intend to use the premises for the exhibition of films at different times to those listed in the column on the left, please list (please read guidance note 6)		
Sat					
Sun					

C

Indoor sporting events Standard days and timings (please read guidance note 7)			<u>Please give further details</u> (please read guidance note 4)
Day	Start	Finish	
Mon			<u>State any seasonal variations for indoor sporting events</u> (please read guidance note 5)
Tue			
Wed			
Thur			<u>Non standard timings. Where you intend to use the premises for indoor sporting events at different times to those listed in the column on the left, please list</u> (please read guidance note 6)
Fri			
Sat			
Sun			

D

Boxing or wrestling entertainments Standard days and timings (please read guidance note 7)			Will the boxing or wrestling entertainment take place indoors or outdoors or both – please tick (please read guidance note 3)	Indoors	
				Outdoors	
				Both	
Day	Start	Finish	Please give further details here (please read guidance note 4)		
Mon					
Tue			State any seasonal variations for boxing or wrestling entertainment (please read guidance note 5)		
Wed					
Thur			Non standard timings. Where you intend to use the premises for boxing or wrestling entertainment at different times to those listed in the column on the left, please list (please read guidance note 6)		
Fri					
Sat					
Sun					

E

Live music Standard days and timings (please read guidance note 7)			Will the performance of live music take place indoors or outdoors or both – please tick (please read guidance note 3)	Indoors	
				Outdoors	
				Both	
Day	Start	Finish			
Mon			Please give further details here (please read guidance note 4)		
Tue					
Wed			State any seasonal variations for the performance of live music (please read guidance note 5)		
Thur					
Fri			Non standard timings. Where you intend to use the premises for the performance of live music at different times to those listed in the column on the left, please list (please read guidance note 6)		
Sat					
Sun					

F

Recorded music Standard days and timings (please read guidance note 7)			<u>Will the playing of recorded music take place indoors or outdoors or both – please tick</u> (please read guidance note 3)	Indoors	
				Outdoors	
				Both	
Day	Start	Finish	<u>Please give further details here</u> (please read guidance note 4)		
Mon					
Tue			<u>State any seasonal variations for the playing of recorded music</u> (please read guidance note 5)		
Wed					
Thur			<u>Non standard timings. Where you intend to use the premises for the playing of recorded music at different times to those listed in the column on the left, please list</u> (please read guidance note 6)		
Fri					
Sat					
Sun					

G

Performances of dance Standard days and timings (please read guidance note 7)			Will the performance of dance take place indoors or outdoors or both – please tick (please read guidance note 3)	Indoors	
				Outdoors	
Day	Start	Finish		Both	
Mon			Please give further details here (please read guidance note 4)		
Tue					
Wed			State any seasonal variations for the performance of dance (please read guidance note 5)		
Thur					
Fri			Non standard timings. Where you intend to use the premises for the performance of dance at different times to those listed in the column on the left, please list (please read guidance note 6)		
Sat					
Sun					

H

Anything of a similar description to that falling within (e), (f) or (g) Standard days and timings (please read guidance note 7)			Please give a description of the type of entertainment you will be providing		
Day	Start	Finish	<u>Will this entertainment take place indoors or outdoors or both – please tick</u> (please read guidance note 3)	Indoors	
Mon				Outdoors	
				Both	
Tue			<u>Please give further details here</u> (please read guidance note 4)		
Wed					
Thur			<u>State any seasonal variations for entertainment of a similar description to that falling within (e), (f) or (g)</u> (please read guidance note 5)		
Fri					
Sat			<u>Non standard timings. Where you intend to use the premises for the entertainment of a similar description to that falling within (e), (f) or (g) at different times to those listed in the column on the left, please list</u> (please read guidance note 6)		
Sun					

I

Late night refreshment Standard days and timings (please read guidance note 7)			Will the provision of late night refreshment take place indoors or outdoors or both – please tick (please read guidance note 3)	Indoors	
				Outdoors	
Day	Start	Finish		Both	
Mon			<u>Please give further details here</u> (please read guidance note 4)		
Tue					
Wed			<u>State any seasonal variations for the provision of late night refreshment</u> (please read guidance note 5)		
Thur					
Fri			<u>Non standard timings. Where you intend to use the premises for the provision of late night refreshment at different times, to those listed in the column on the left, please list</u> (please read guidance note 6)		
Sat					
Sun					

J

Supply of alcohol Standard days and timings (please read guidance note 7)			Will the supply of alcohol be for consumption – please tick (please read guidance note 8)	On the premises	
				Off the premises	X
				Both	
Day	Start	Finish	State any seasonal variations for the supply of alcohol (please read guidance note 5) N/A		
Mon	08:00	01:00			
Tue	08:00	01:00			
Wed	08:00	01:00			
Thur	08:00	01:00			
Fri	08:00	01:00			
Sat	08:00	01:00			
Sun	08:00	01:00	Non standard timings. Where you intend to use the premises for the supply of alcohol at different times to those listed in the column on the left, please list (please read guidance note 6) N/A		

State the name and details of the individual whom you wish to specify on the licence as designated premises supervisor (Please see declaration about the entitlement to work in the checklist at the end of the form):

Name	MR ALAN HUSSEINPOOR
Date of birth	
Address	
Postcode	
Personal licence number (if known)	LEIPRS5056

Issuing licensing authority (if known) LEICESTER

K

Please highlight any adult entertainment or services, activities, other entertainment or matters ancillary to the use of the premises that may give rise to concern in respect of children (please read guidance note 9).

N/A

L

Hours premises are open to the public Standard days and timings (please read guidance note 7)			State any seasonal variations (please read guidance note 5) N/A
Day	Start	Finish	Non standard timings. Where you intend the premises to be open to the public at different times from those listed in the column on the left, please list (please read guidance note 6) N/A
Mon	08:00	01:00	
Tue	08:00	01:00	
Wed	08:00	01:00	
Thur	08:00	01:00	
Fri	08:00	01:00	
Sat	08:00	01:00	

Sun	08:00	01:00	

M

Describe the steps you intend to take to promote the four licensing objectives:

a) General – all four licensing objectives (b, c, d and e) (please read guidance note 10)

Train all staff on licensing laws. Keep records of training and follow all conditions of the premises license

b) The prevention of crime and disorder

Use CCTV to monitor the premises, with a member of staff onsite at all times. Refuse sales to drunk, aggressive or people under any influence and report incidents to the Police as and when necessary

c) Public safety

Keep the shop tidy and free of hazards, check alcohol stock for safety (ie tampering, upon arrival)

d) The prevention of public nuisance

Manage the noise from the property by being respectful of the neighbourhood when receiving deliveries and follow prescribed opening times

e) The protection of children from harm

Check I.D. for anyone who looks under the age of 25. Train staff on age verification procedures and controls (Challenge 25 policy) and display appropriate age verification signage internally

Checklist:

Please tick to indicate agreement

•	I have made or enclosed payment of the fee.	X
•	I have enclosed the plan of the premises.	X
•	I have sent copies of this application and the plan to responsible authorities and others where applicable.	X
•	I have enclosed the consent form completed by the individual I wish to be designated premises supervisor, if applicable.	X
•	I understand that I must now advertise my application.	X
•	I understand that if I do not comply with the above requirements my application will be rejected.	X
•	[Applicable to all individual applicants, including those in a partnership which is not a limited liability partnership, but not companies or limited liability partnerships] I have included documents demonstrating my entitlement to work in the United Kingdom or my share code issued by the Home Office online right to work checking service (please read note 15).	

It is an offence, under Section 158 of the Licensing Act 2003, to make a false statement in or in connection with this application. Those who make a false statement may be liable on summary conviction to a fine of any amount.

It is an offence under Section 24b of the Immigration Act 1971 for a person to work when they know, or have reasonable cause to believe, that they are disqualified from doing so by reason of their immigration status. Those who employ an adult without leave or who is subject to conditions as to employment will be liable to a civil penalty under section 15 of the Immigration, Asylum and Nationality Act 2006 and pursuant to Section 21 of the same act, will be committing an offence where they do so in the knowledge, or with reasonable cause to believe, that the employee is disqualified.

Part 4 – Signatures (please read guidance note 11)

Signature of applicant or applicant's solicitor or other duly authorised agent (see guidance note 12). **If signing on behalf of the applicant, please state in what capacity.**

Declaration	<ul style="list-style-type: none"> [Applicable to individual applicants only, including those in a partnership which is not a limited liability partnership] I understand I am not entitled to be issued with a licence if I do not have the entitlement to live and work in the UK (or if I am subject to a condition preventing me from doing work relating to the carrying on of a licensable activity) and that my licence will become invalid if I cease to be entitled to live and work in
--------------------	---

Declaration	<ul style="list-style-type: none"> [Applicable to individual applicants only, including those in a partnership which is not a limited liability partnership] I understand I am not entitled to be issued with a licence if I do not have the entitlement to live and work in the UK (or if I am subject to a condition preventing me from doing work relating to the carrying on of a licensable activity) and that my licence will become invalid if I cease to be entitled to live and work in the UK (please read guidance note 15). The DPS named in this application form is entitled to work in the UK (and is not subject to conditions preventing him or her from doing work relating to a licensable activity) and I have seen a copy of his or her proof of entitlement to work, or have conducted an online right to work check using the Home Office online right to work checking service which confirmed their right to work (please see note 15)
Signature	
Date	18 TH March 2025
Capacity	Director, Ranya Leicester Ltd

For joint applications, signature of 2nd applicant or 2nd applicant's solicitor or other authorised agent (please read guidance note 13). If signing on behalf of the applicant, please state in what capacity.

Signature	
Date	
Capacity	

Contact name (where not previously given) and postal address for correspondence associated with this application (please read guidance note 14)

Ranya Leicester Ltd, 24 Braunstone Gate

Post town	Leicester	Postcode	LE3 5LG
-----------	-----------	----------	---------

Telephone number (if any)	
---------------------------	--

If you would prefer us to correspond with you by e-mail, your e-mail address (optional)

Notes for Guidance

- Describe the premises, for example the type of premises, its general situation and layout and any other information which could be relevant to the licensing objectives. Where your application includes off-supplies of alcohol and you intend to provide a place for consumption of these off-supplies, you must include a description of where the place will be and its proximity to the premises.
- In terms of specific regulated entertainments please note that:
 - Plays: no licence is required for performances between 08:00 and 23:00 on any day, provided that the audience does not exceed 500.

Consent of individual to being specified as premises supervisor

.....
I, Mr Alan Husseinpoor
[full name of prospective premises supervisor]



.....
[home address of prospective premises supervisor]

hereby confirm that I give my consent to be specified as the designated premises supervisor in relation to the application for

Off License

.....
[type of application]

by

Ranya Leicester Ltd

.....
[name of applicant]

.....
relating to a premises licence

[number of existing licence, if any]

for

Ranya Leicester Ltd, 24 Braunstone Gate, Leicester, LE3 5LG

.....
[name and address of premises to which the application relates]

and any premises licence to be granted or varied in respect of this application made by

Ranya Leicester Ltd

[name of applicant]

concerning the supply of alcohol at

24 Braunstone Gate, Leicester, LE3 5LG

[name and address of premises to which application relates]

I also confirm that I am entitled to work in the United Kingdom and am applying for, intend to apply for or currently hold a personal licence, details of which I set out below.

Personal licence number

LEIPRS 5056

[insert personal licence number, if any]

Personal licence issuing authority

Leicester City Council

[insert name and address and telephone number of personal licence issuing authority, if any]

/ 

Signed

Mr Alan Husseinpoor

Name (please print)

14/03/2025

Date

NOTE

Any personal data that you provide will be processed in accordance with current data protection laws. It will be used by Leicester City Council and our partners to deliver

Main Road
Front entrance

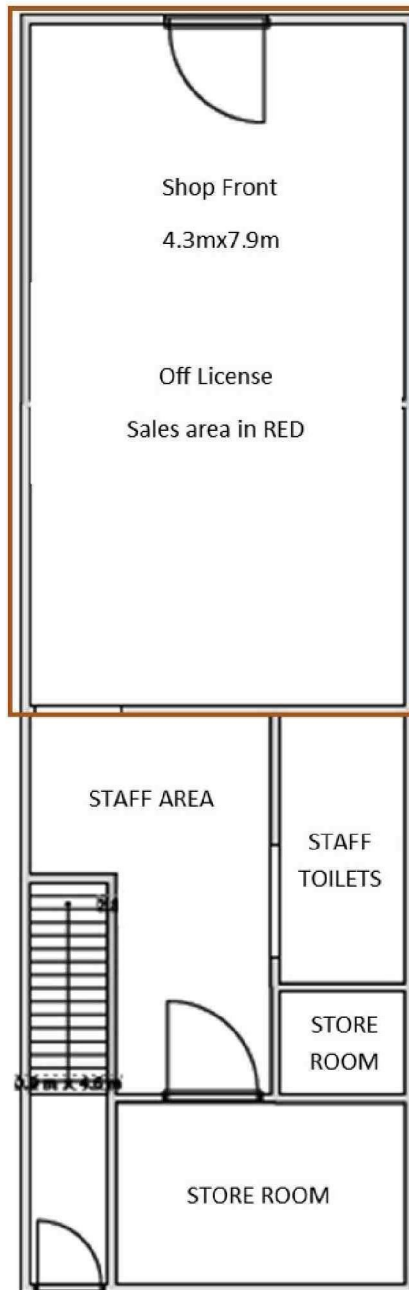

Licensing floorplan for:

Rayna Leicester Ltd

24, Braunstone Gate, Leicester, LE3 5LG



**Leicestershire
Police**

Protecting our communities

Force Licensing Department
Mansfield House
74 Belgrave Gate
Leicester LE1 3GG

Tel: 101

www.leics.police.uk

Leicestershire Police

Licensing Act 2003

Representation in respect of a new premises licence application

Details of person or body making representation	
Your Name:	PC Jefferson Pritchard
Your Address:	Mansfield House, 74 Belgrave Gate, Leicester LE1 3GG

Details of premises representation is about	
Name of Premises:	Ranya Leicester Ltd
Address of premises:	24 Braunstone Gate Leicester LE3 5LG
Application No. (if known)	

Please tick one or more of the licensing objectives that your representation relates to:	
Prevention of crime and disorder	X
Public Safety	X
Prevention of public nuisance	X
Protection of children from harm	X

Please summarise your concerns about this application:
<p>I write in my capacity as Leicester City Centre's alcohol licensing officer for Leicestershire Police, with delegated authority from the Chief Constable.</p> <p>My representation to this new premises licence application is based upon the licensing objectives, as per the Licensing Act 2003.</p> <p>The application in its current format would undermine all four licensing objectives if granted. Those being:</p> <ul style="list-style-type: none"> (1) The prevention of crime and disorder. (2) Public Safety. (3) The prevention of public nuisance.

(4) The protection of children from harm.

The application is for a new off-licence, in which alcohol will be supplied for consumption off the premises only.

The premises is located on Braunstone Gate within the West End part of the city.

The premises is located within the Narborough Road / Braunstone Gate “area of special interest” as per Leicester City Council’s Statement of Licensing Policy dated 2022-2027. The application makes no reference to this policy, so it unclear if the operator has considered the significance of the area.

The premises intends to operate daily between 8am and 1am, with no seasonal variations. The hours permitted for the supply of alcohol for consumption off the premises will mirror the opening hours.

The applicant has elected to licence only half of the building, with a large unlicensed area located at the rear. Therefore, customers could purchase alcohol from the premises and consume it within the rear area, as this would be classified as “off the premises”.

The application itself is extremely vague when it refers to the steps it will take to promote the four licensing objectives. The steps are vague and un-enforceable from a responsible authority’s perspective. Any conditions need to be precise, reasonable and more importantly enforceable.

The application makes no reference to basic requirements such as CCTV retention periods, number and position of such cameras. Likewise, the application makes no reference to a Challenge Policy and how the operator will ensure this is enforced. Overall, the application lacks specific details about how the operator will promote the licensing objectives.

Several other licensed premises which supply alcohol for consumption both on and off the premises are located within close proximity.

Alcohol related anti-social behaviour and violent crime in the area is a neighbourhood priority. Therefore, the police do have concerns that persons already under the influence of alcohol who are set on causing issues within the local community will have another premises in which to buy alcohol from.

Therefore, Leicestershire Police respectfully requests the application is refused, as it fails to promote all four licensing objectives.

PC2093 Jefferson Pritchard
Leicestershire Police
Thursday 10th April 2025

CONDITIONS

CONDITIONS CONSISTENT WITH THE OPERATING SCHEDULE
Train all staff on licensing laws. Keep records of training and follow all conditions of the premises licence
Use CCTV to monitor the premises, with a member of staff onsite at all times. Refuse sales to drunk, aggressive or people under any influence and report incidents to the Police as and when necessary
Keep the shop tidy and free of hazards, check alcohol stock for safety (ie tampering, upon arrival)
Manage the noise from the property by being respectful of the neighbourhood when receiving deliveries and follow prescribed opening times
Check I.D. for anyone who looks under the age of 25. Train staff on age verification procedures and controls (Challenge 25 policy) and display appropriate age verification signage internally

